

CERTIFIED RECORD OF LAND CORNER MONUMENTATION

History of original corner establishment: *

The original corner was established in 1881 by Rufus S. Moore under Contract No. 382.
The original notes state:
North between secs 32 & 33
40.00 Set a basalt stone 24x8x6 and made a mound of stone.

DIAGRAM
T10S R31E
1/4
S321S33

Description of corner evidence found:

Found no evidence of the original corner.

Description of monument and accessories I establish to perpetuate the original location of this corner:

I reestablished this corner by single proportion. Set a 2-1/2"x30" aluminum monument 20" in the ground in a mound of stone.
I establish new bearing trees:
An 8" Juniper bears N 19°24' W, 39.7 ft, scribed 1/4S32BT.
An 8" Juniper bears S 53°31' E, 32.6 ft, scribed 1/4S33BT.

T10S R31E
1/4
S321S33
PLS1918
1989

Sun Cadastral Survey
Contract No.: 53-04H1-7-4011
Project No.: 8722JB
Field Book: 7-35
Work Accomplished: 4/9/89
Witnesses: Louise Parsons

New BTs have 3/4" brass washers marked PLS1918 attached to the BT blaze, faces and bands painted with red tree marking paint, and BT tags and Attention or Land Survey Monument signs. A steel fence post with Attention or Land Survey Monument sign is driven approximately 3-5 feet from the corner.

PARSONS SURVEYING
1915 S.E. Stone Street
Corvallis, OR 97333
(503) 752-7515

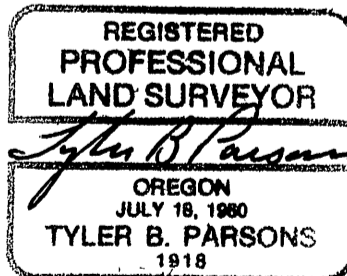

Office of COUNTY SURVEYOR County of GRANT
State of OREGON, I hereby certify that the within instrument was filed in this office
for record on the 26 day of June, 1989

Roland D. Duggett by _____
(COUNTY OFFICIAL) (DEPUTY)